

GRT3-100 | Glass room thermo-regulator

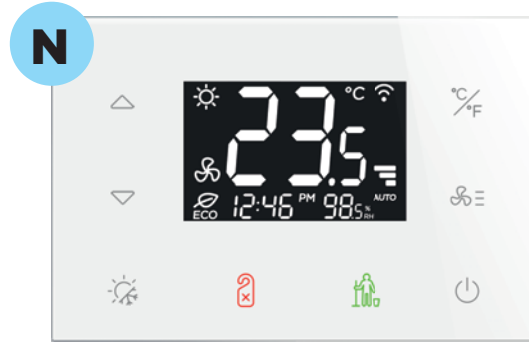



EAN code: GRT3-100/W: 8595188191746, GRT3-100/B: 8595188191739
 Order Code: GRT3-100/W: 9174, GRT3-100/B: 9173
 The picture of device is illustrative, the icons (symbols) are configurable by the customer.

Technical parameters	GRT3-100/B	GRT3-100/W
Outputs		
Relays:	5x switching / 5A / 250V AC1 / 1385VA	
Contact life:	mechanical: 10 mil. / electrical 100.000 switches	
Mains voltage detection:	yes (relay switching in zero)	
Analog Output:	2x 0-10V, 10 mA	
Inputs (external)		
yes (relay switching in zero)		
Binary:	1x potential-free contact, terminals IN1/IN2 against GND, maximum wire length 30m	
Temperature:	1x for external temperature sensor TC/TZ, terminals IN1/T & IN2/TC, temperature range -20 to +120 °C, accuracy ± 0.5 °C	
Sensors (internal)		
Temperature:	range 0 to +55 °C, accuracy ± 0.5 °C from the range	
Humidity:	0 - 99% RH, accuracy ± 3 °C from the range	
Lighting:	adaptive backlight control of the display and buttons	
Communications		
iNELS BUS:	BUS	
MODBUS	Configurable by IDM	
Power supply		
Supply voltage BUS:	27 V DC	
Tolerance/ rated current:	-20/+10, ??? mA	
Control and display		
Display:	LCD (VA/TN), active area 54 x 34mm	
Buttons:	8x, capacitive, backlit	
Mechanics		
Operating temperature:	- 0 to 50 °C / max 90% RH	
Storage temperature:	- 20 to 60 °C	
Enclosure:	IP30 (mounted)	
Overvoltage category:	II.	
Pollution degree:	2	
Working position:	horizontal	
Installation:	on EU or British box with 60 mm bolt spacing	
Terminals:	min. 0.2 mm ² /max 1.5 mm ² with sleeve 18 pole, screwless (push-in)	
Dimension:	120 x 80 x 27 mm	
Weight:	230g	
Shape/edges:	sharp	
Color (glass and plastic)	White	Black
Standard:	EN 63044-1	

- Glass room thermo-regulator GRT3-100 is part of a comprehensive range of glass iNELS control units for apartments, guest room management system (GRMS) and serves to regulate the temperature in the room.
- The glass room thermo-regulator is a design component of the iNELS system and is available in elegant black (GRT3-100/B) and white (GRT3-100/W) version.
- GRT3-100 thermo-regulator has a display for displaying the current room temperature and desired temperature. To adjust the required temperature, it is possible to use the touch buttons with symbols "▽" and "△".
- The GRT3-100 is equipped with 5x 5 A relay output for fan speed and valves. It is also equipped with analog-to-digital input (AIN/DIN), which can be used to connect potential-free contact or external temperature sensor TC/ TZ (for example temperature measurement of the room or floor).
- GRT3-100 is also suitable for controlling fan coils and fan speed can be easily adjusted by using the touch buttons with symbols.
- Thermo-regulator GRT3-100 also features its touch buttons whose function can be adjusted by software, for example fan coil on/off, heating/cooling or comfort temperature for heating or cooling.
- The unit has synchronized closing and opening of the relay in the zero-voltage of the sinusoidal waveform. Sync input L against N terminal.
- Thermo-regulator is equipped with an integrated temperature sensor for ambient temperature measurement.
- Engraving of symbols is possible upon a request.
- Individual symbols can be illuminated.
- GRT3-100 are designed for mounting into wall.

Options: external temperature sensors

TC-0	TC-3	TC-6, TC-12	NTC 12K 2 x 0,25 mm ² PVC, IP67
			
100 mm	3 m		
Order code: 209970800010	Order code: 209970800011		

Create your glass design here:
icons.inels.com



GRT3-100 | Glass room thermo-regulator

Buttons and display description

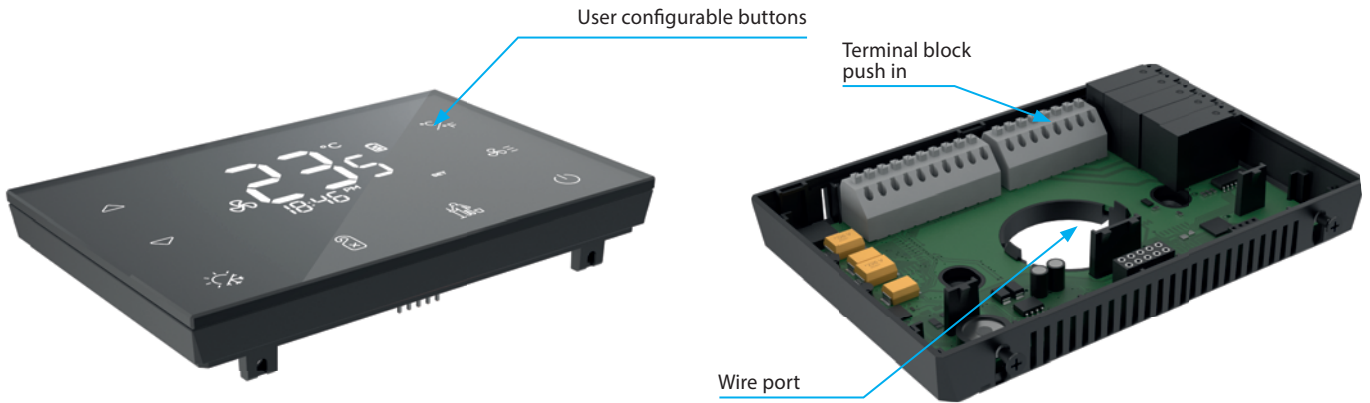

Connection

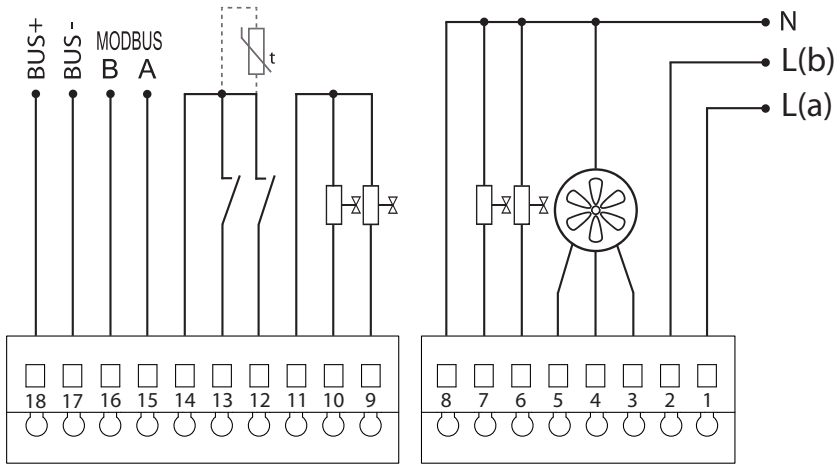

- 1. L(a) power supply phase wire
- 2. L(b) phase - identical to phase L(a) - see.*
- 3. HIGH fan top speed
- 4. MED fan medium speed
- 5. LOW fan lowest speed
- 6. HEAT valve 0/1 for heating
- 7. COOL valve 0/1 for cooling
- 8. N neutral wire power supply -synchronization (zero switching)
- 9. 1:0-10V 1. analog output 0-10V
- 10. 2:0-10V 2. analog output 0-10V
- 11. GND common terminal for analog output
- 12. IN1 1. binary input for external contact
- 13. IN2 2. binary input for external contact
- 14. COM common terminal for binary inputs 1. and 2.
- 15. BUS A Modbus A
- 16. BUS B Modbus B
- 17. BUS - BUS -
- 18. BUS + BUS +

Option for an external temperature sensor TC/TZ

- 12. IN1 temperature input NTC
- 13. IN2 temperature input NTC

* in the case of an auxiliary heater, it is connected to terminals 6 or 7 (max. 1500 W).

Another view



GRT3-100/W



GRT3-100/B